



TOWNSHIP OF/CANTON DE Tiny

A site diagram identifies buildings, structures and other features in relation to a property.

A site diagram is required to be submitted with every short term rental accommodation license application per Township By-law 22-017.

The following information must be shown on a site diagram:

- Title and scale
- Street name(s)
- North arrow
- Property lines with dimensions
- All existing buildings and structures including the location of the sewage system and well (if applicable)
- The use of all existing buildings and structures (i.e. house, garage, shed, deck, etc.)
- Parking area and number of parking spaces with dimensions
- The type of surface of the parking area. It is noted that the parking area shall consist of a hard-surfaced driveway (gravel, paved, concrete, interlock or similar hard surface). Vehicles may only park in the parking area.

NOTES:

1. Do not submit this sample site diagram as part of any short term rental accommodation license application.
2. The site diagram must match the floor plan submitted.
3. The site diagram must be provided to scale.
4. The minimum required parking space size is 3 metres (10 feet) by 6 metres (20 feet).

TOWNSHIP OF TINY SITE DIAGRAM SAMPLE

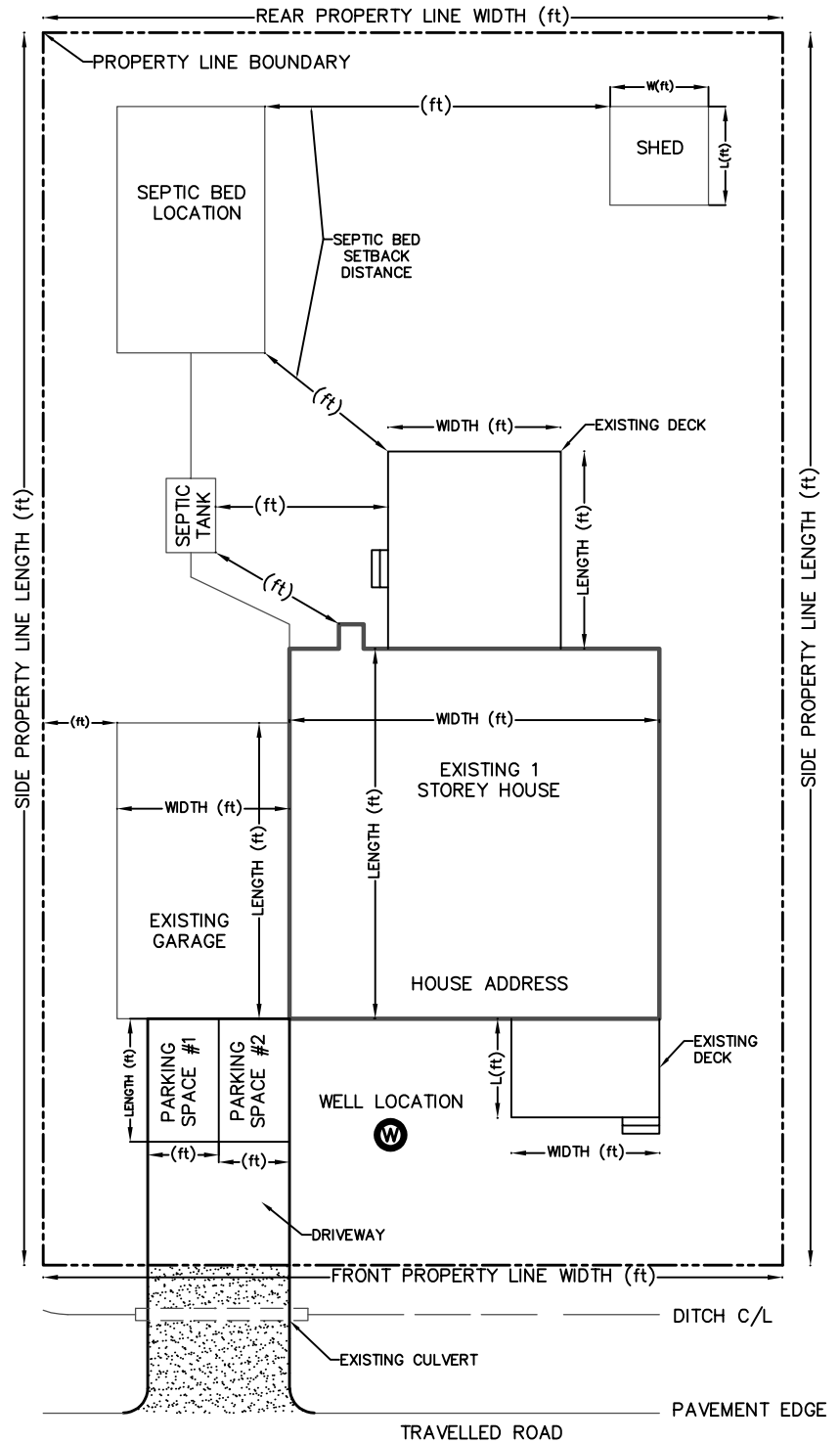

REV. DATE: 10/20/2022

SCALE: