



# Tiny

A floor plan identifies the layout of the occupancy as well as key features required as part of the application process

A floor plan is required to be submitted with every short-term rental application as per Township By-law 22-017.

The following information must be shown on the floor plan:





- Municipal address of the property
- Layout of all rooms and spaces on each storey
- Use of each room
- Location, size, and type of all bedroom windows (ex. slider, casement, etc.)
- Location and type of smoke and carbon monoxide alarms (ex. hardwired, interconnected, battery-only, strobe)
- Location of fire extinguishers
- Location of records of tests and maintenance of smoke and carbon monoxide alarms, early warning devices and fire extinguishers
- Location and type of all gas and electric appliances and heating equipment
- Location of electrical panel
- Location and type of all fireplaces, stoves (gas, wood) and fuel burning appliances
- Location of all plumbing fixtures (ex. sinks, toilet, shower, etc.)
- All entrances/exits to and from building

### NOTES:

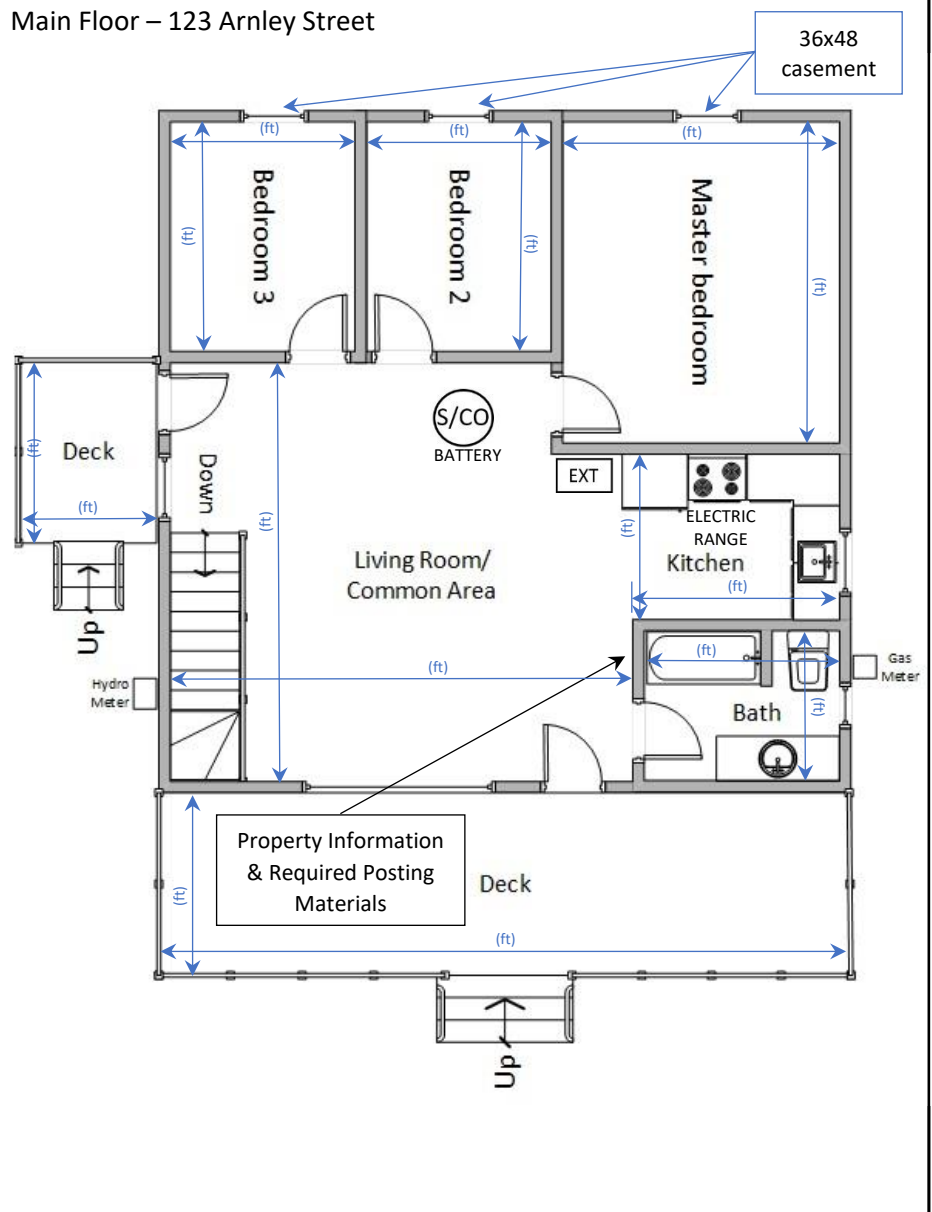
1. Do not submit this sample floor layout with your application.
2. Use a separate sheet for each storey/floor

Main Floor – 123 Arnley Street



-  Combination Smoke & Carbon Monoxide Alarm
-  Smoke Alarm
-  Carbon Monoxide Alarm
-  Portable Fire Extinguisher